

# Mandala Star App User Manual

## Mandala Astral Star



Please read the manual before using the tools.

Version 4.1

## Table of Contents

<b>1</b>	<b><i>Android Device Specification Requirement</i></b> .....	<b>2</b>
<b>2</b>	<b><i>Mobile Application End-User License Agreement</i></b> .....	<b>3</b>
<b>3</b>	<b><i>Application Download and Installation</i></b> .....	<b>4</b>
<b>4</b>	<b><i>Mandala Star Application Main Page Features</i></b> .....	<b>7</b>
<b>5</b>	<b><i>Application Setup</i></b> .....	<b>8</b>
5.1	<b>Application Activation</b> .....	<b>9</b>
5.2	<b>Tablet Bluetooth Connection Setup</b> .....	<b>10</b>
5.3	<b>Application Settings</b> .....	<b>11</b>
5.3.1	<b>Bluetooth Connection Setup:</b> .....	<b>11</b>
5.3.2	<b>General Setting</b> .....	<b>12</b>
5.3.3	<b>Mandala Dynamic Scan Setting</b> .....	<b>13</b>
5.3.4	<b>Light Alchemy Pulsar Setting</b> .....	<b>13</b>
5.3.5	<b>Application Activation Status</b> .....	<b>14</b>
<b>6</b>	<b><i>Mandala Astral Star</i></b> .....	<b>15</b>
6.1	<b>Library</b> .....	<b>15</b>
6.1.1	<b>Pattern/item Laser Light Color Selection</b> .....	<b>17</b>
6.2	<b>Pre Scan</b> .....	<b>18</b>
6.3	<b>Scan</b> .....	<b>19</b>
6.3.1	<b>Combine Scan</b> .....	<b>20</b>
6.3.2	<b>Multiple Scan</b> .....	<b>23</b>
6.4	<b>Preset</b> .....	<b>25</b>
6.4.1	<b>Basic Preset</b> .....	<b>26</b>
6.4.2	<b>Create Preset</b> .....	<b>28</b>
6.4.3	<b>Preset Play Mode</b> .....	<b>30</b>
6.5	<b>Online Presets</b> .....	<b>32</b>
6.5.1	<b>Download Preset</b> .....	<b>32</b>
6.5.2	<b>Upload Preset</b> .....	<b>33</b>

## 1 Android Device Specification Requirement

Mandala Star application can only be operated with **Android mobile phone or tablet.**

### Minimum requirement:

<b>Operating System:</b>	Android OS
<b>Android version:</b>	Android 10.0 or higher
<b>Others:</b>	Bluetooth and WIFI function



## 2 Mobile Application End-User License Agreement

Please read this Mobile Application End-User License Agreement (“EULA”) carefully before downloading or using the Mandala Star App mobile application (“the application”). This EULA governs your use of the application, which will allow you to access Light Mandalas library and control Light Mandalas tools by your mobile device. Your use of the application indicates your consent to this EULA.

- 1. License.** Light Mandalas Co., Ltd. grants you a revocable, non-exclusive, non-transferable, limited license to download, install, and use the application for your personal and internal business purposes strictly in accordance with this EULA
- 2. Your Account.** Your use of the application requires that you have an account with Light Mandalas.
- 3. Changes to this EULA.** Light Mandalas reserves the right to modify this EULA. Your continued use of the application after Light Mandalas publishes notice of changes to this EULA indicates your consent to the updated terms.
- 4. No Included Maintenance and Support.** Light Mandalas may deploy changes, updates, or enhancements to the application at any time. Light Mandalas may provide maintenance and support for the application, but has no obligation whatsoever to furnish such services to you and may terminate such services at any time without notice. You acknowledge that Google has an obligation to furnish any maintenance and/or support services in connection with the application.
- 5. Acceptable Use.** You agree that you will not use or encourage others to use the application in a way that could harm or impair others’ use of the Mobile App.
- 6. Privacy.** Light Mandalas don’t collect your information from your application. Information inside the application will be private.
- 7. No Warranty.** Your use of the application is at your sole risk. The application is provided on an “As Is” and “As Available” basis. Light Mandalas expressly disclaims all warranties of any kind.
- 8. Suspension and Termination of the application.** Light Mandalas reserves the right to suspend or terminate your access to the application at any time.
- 9. Intellectual Property Rights.** In the event of a third-party claim that the application, or your possession and use of the application, infringes third party’s intellectual property rights, Light Mandalas, will be solely responsible for the investigation, defense, settlement and discharge of any such intellectual property infringement claim.

### 3 Application Download and Installation

User can download Mandala Star app from either “Google Play Store” or “Huawei AppGallery”

1. Open “Google Play Store” or “Huawei AppGallery” application



2. In the “Google Play Store” Search bar, type “Mandala Star”  
In the “Huawei AppGallery” Search bar, type “星光曼陀罗”

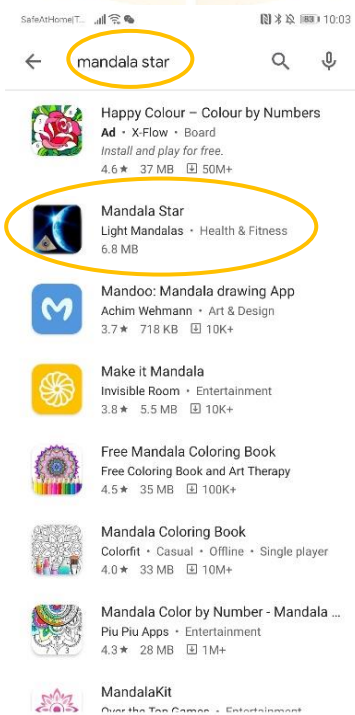

### 3. Tap on Install to install the app.

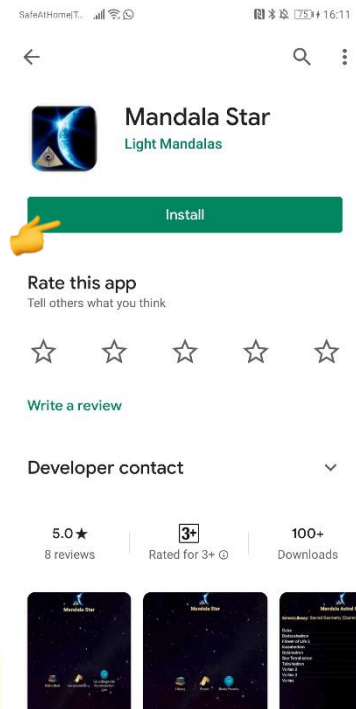

### 4. Allow application permission

#### 4.1 Go to Tablet Settings

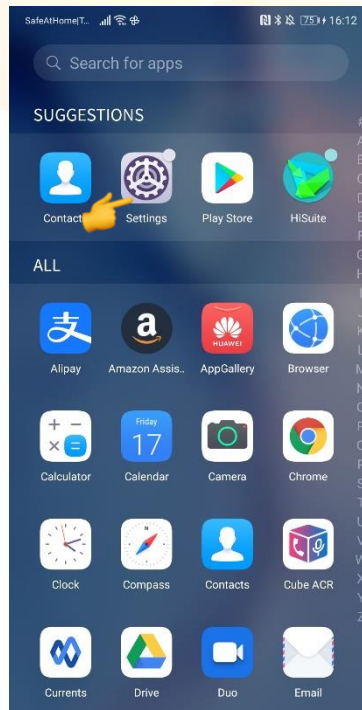

## 4.2 Go to “Apps” then tap on “Apps” and search for “Mandala Star”.

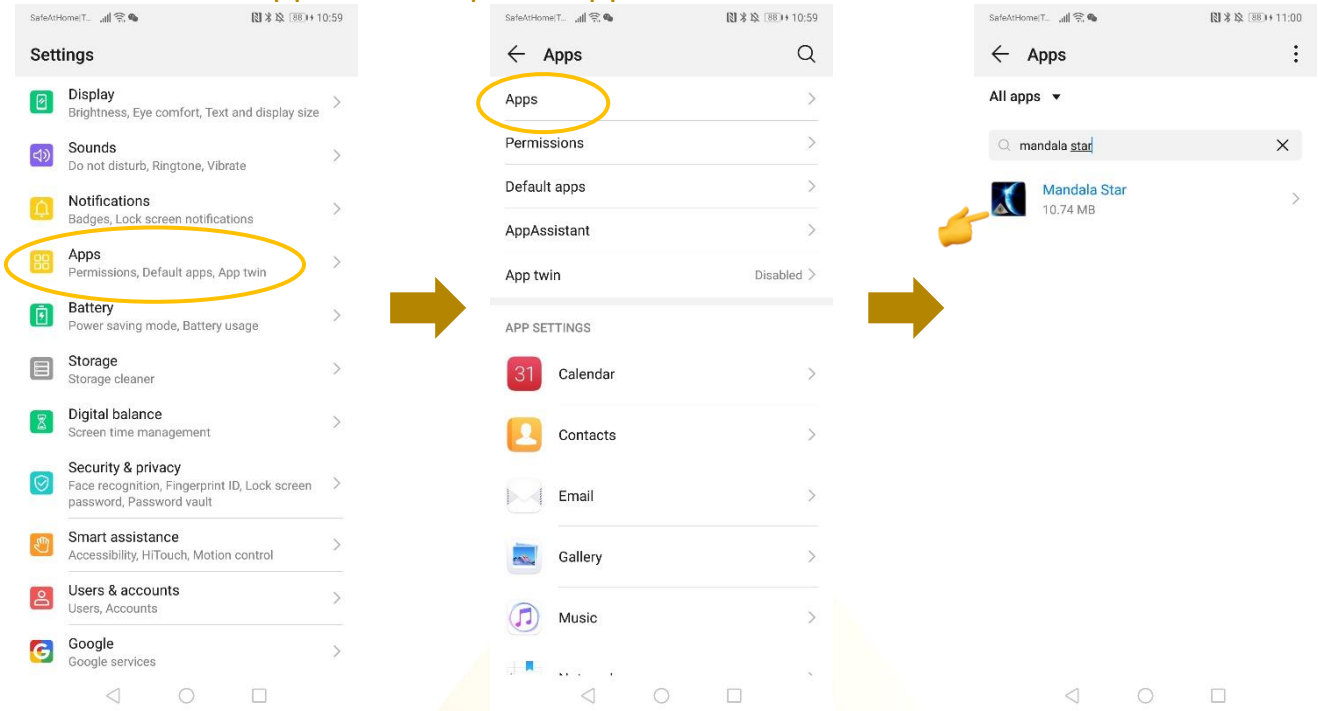

## 4.3 Tap on “Permissions” then switch on “Storage”

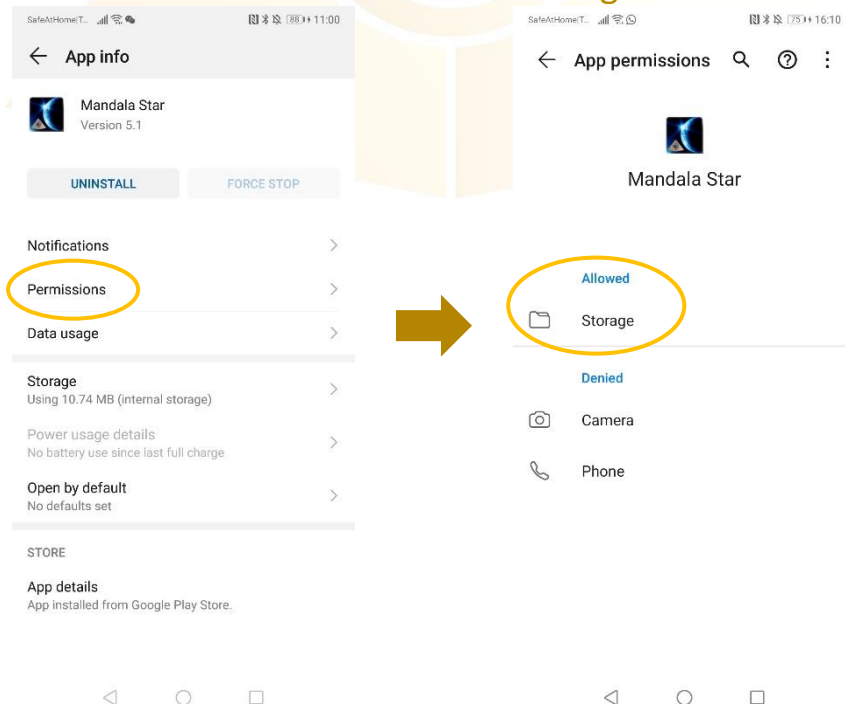

## 4 Mandala Star Application Main Page Features



1 - 7 are different Light Mandalas devices programs. User can use specific program to operate specific device.

**1. Mandala Astral Star**

**2. Mandala VN Star**

**3. Mandala Scan**

**4. Psycho Spiritual Integration – PSI**

- PSI library has to be purchased prior to use this program
- Has to use with Mandala Scan.

**5. Light Alchemy Pulsar**

**6. Mandala Wand**

**7. Gravity Plate**

**8. Mandala Resonator**

**9. Mandala Violet Shield**

**10. Magnetic Pulsar**

**11. Information:** Provide user the latest application update information.

**12. User:** Create new user profile

**13. Activation:** Activate the application with activation code

**14. Setting:** Application Setting – Bluetooth Device Pairing, Mandala Scan Setting, Light Alchemy Setting, Language setting, Database refresh and Activation Code Release

**15. Exit:** Exit from the application



## 5 Application Setup

Once the app is opened, the “New User Create” will prompt out. Fill in the User profile and then tap on confirm to create new user profile. User also can insert their profile picture by tap on the picture insert. The user’s name will appear on the Home Page.

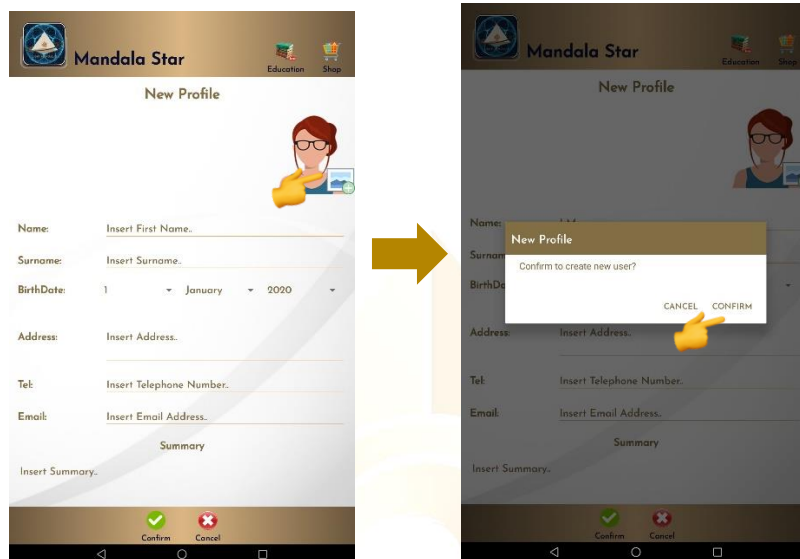

User can also add new user manually. User → New User

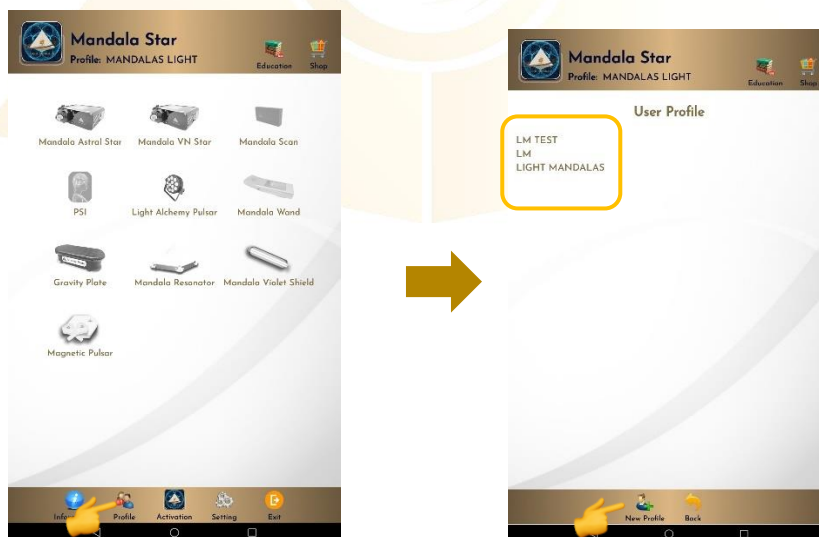

## 5.1 Application Activation

Tap on “**Activation**” to activate the special libraries (PSI and Homeopathy library). Insert the activation code and tap confirm.

*\*User has to purchase for the libraries and can request activation code from the dealer/local agent.*

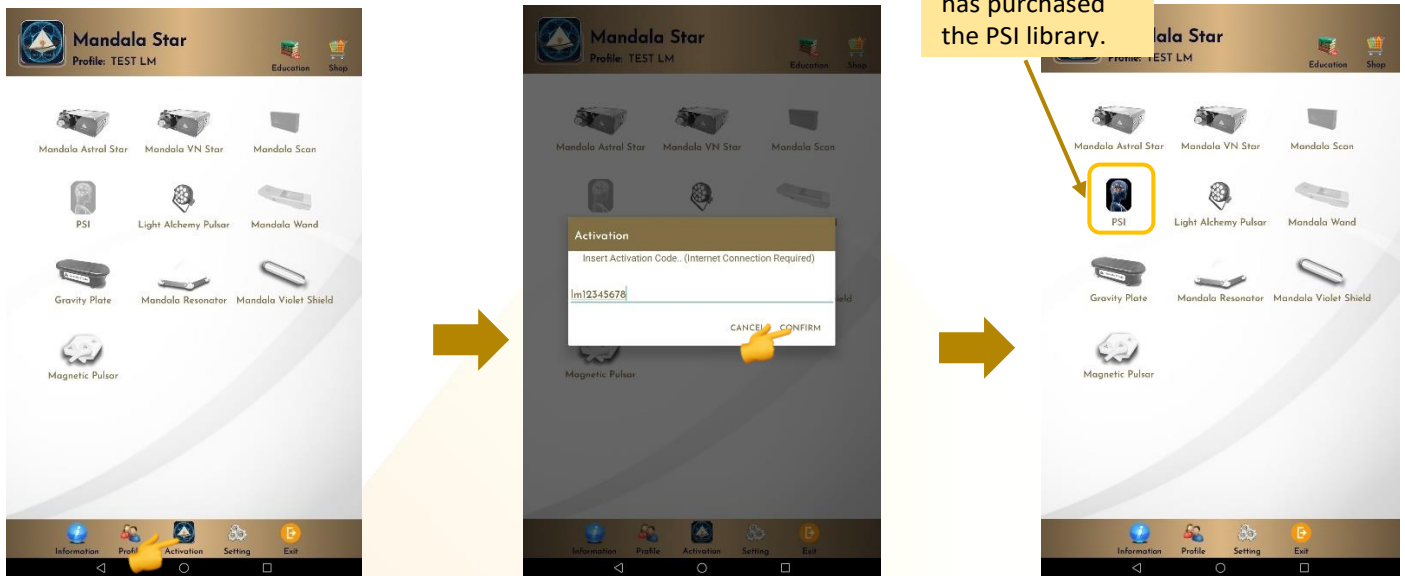

## 5.2 Tablet Bluetooth Connection Setup

1. In the android device, go to Setting then turn ON the Bluetooth and tap on scan to scan for the Light Mandalas device name.

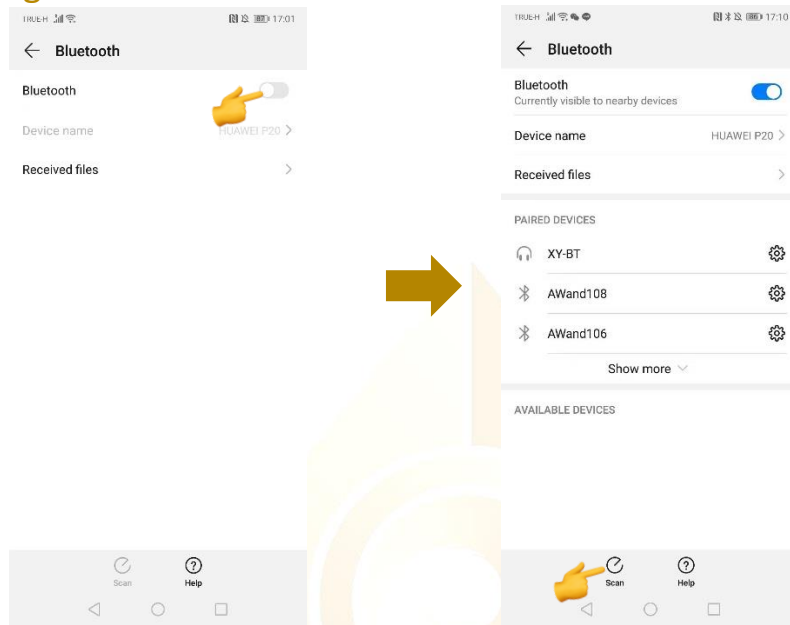

2. When the Light Mandalas device name appear, tap on it and insert password: "1234" then tap OK to pair it.

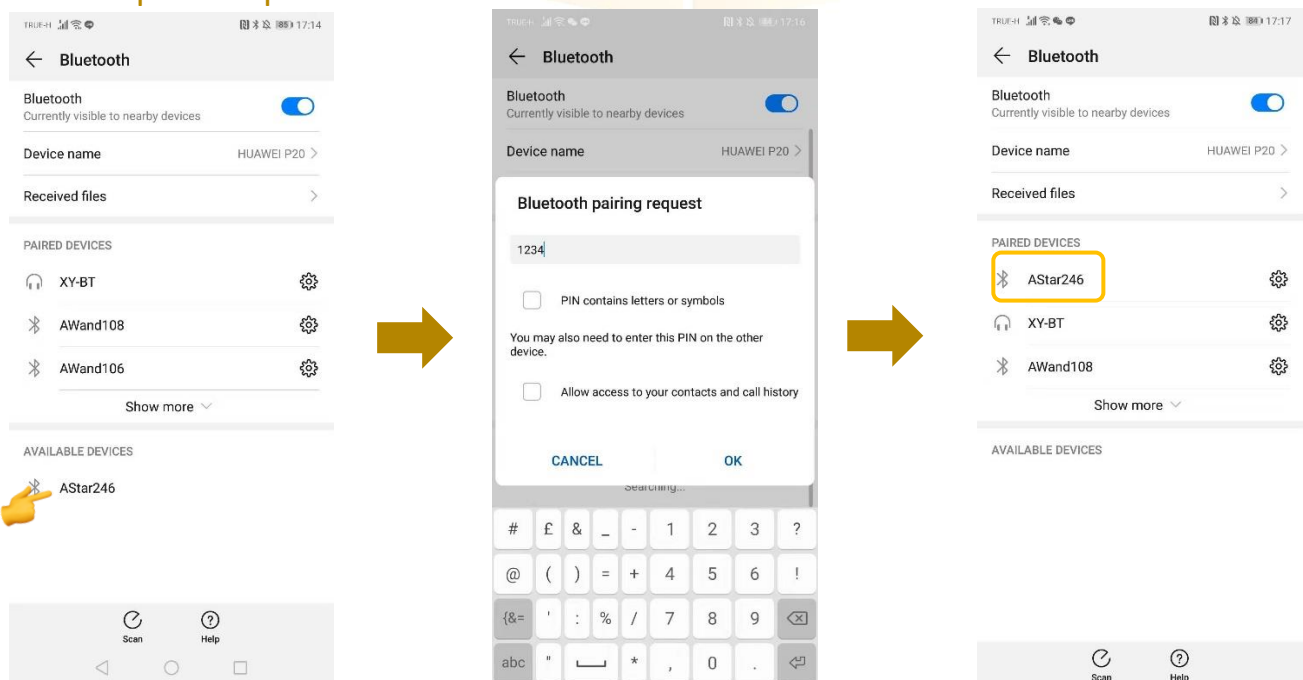

## 5.3 Application Settings

### 5.3.1 Bluetooth Connection Setup:

1. Go to the Mandala Star application **Setting**, tab on the device which you want to pair with and choose the specific device name and choose the version of the device. Then tap **Back**.

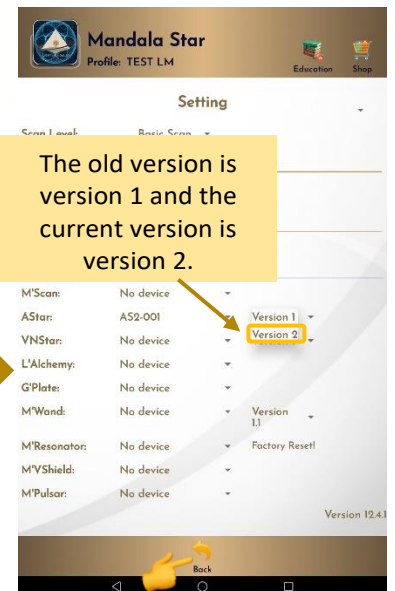
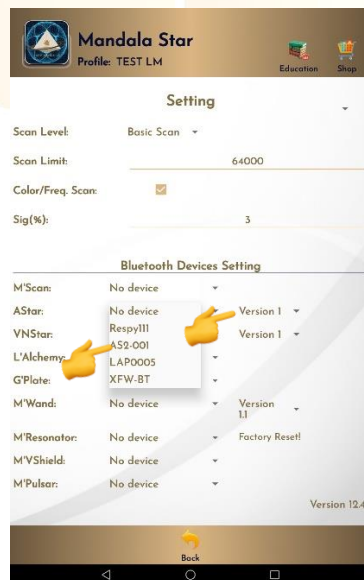

2. The icon of the device in the Home Page will turn on (turn to color icon) when the device name is set in the application setting.



### 5.3.2 General Setting

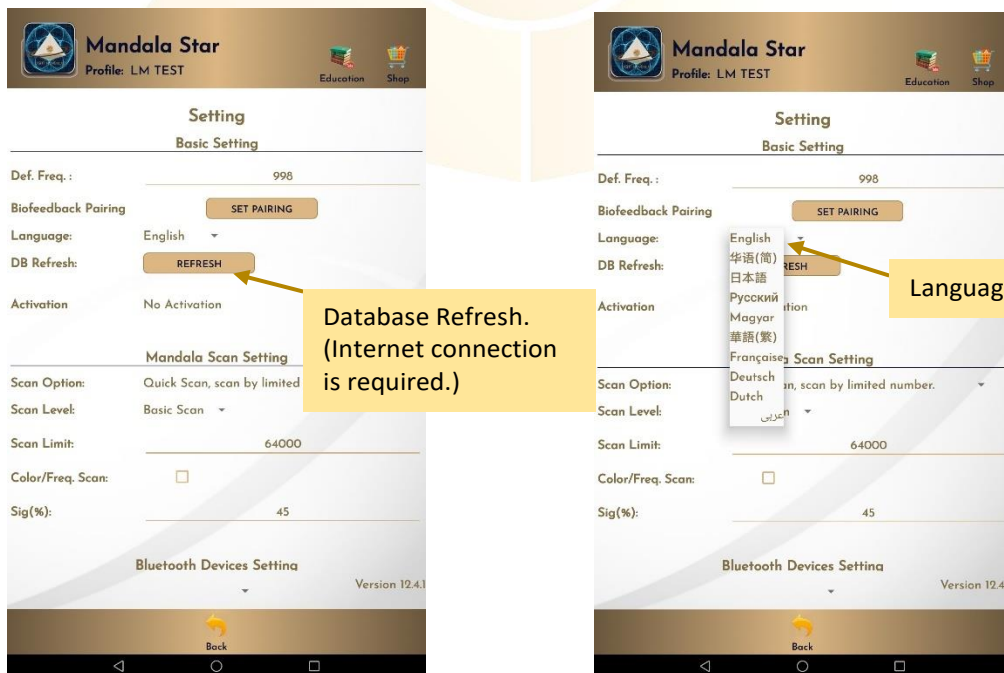

### 5.3.3 Mandala Dynamic Scan Setting

#### Scan Level:

1. Basic Scan: will scan on blue and green state.
2. Deep Scan: will scan only on green state.

#### Colour/Freq. Scan:

##### Colour Scan for Astral Star and VN Star:

- Tick: different colors preset scan results
- Untick: white color preset scan results

##### Freq. Scan for Light Alchemy Pulsar:

- Tick: different frequencies preset scan results
- Untick: default frequency preset scan results

##### Freq. Scan for Mandala Wand:

- Tick: different color preset and laser scan results
- Untick: no color preset and all laser ON (FULL) scan results



#### Scan Option:

1. Quick Scan: scan by number added.
2. Bio Matrix Scan: scan by human body coherence. (No limit)

#### Scan Limit:

Set the scan numbers for Quick Scan.

#### Sig. (%):

the significant of the scan result that focus on.

### 5.3.4 Light Alchemy Pulsar Setting

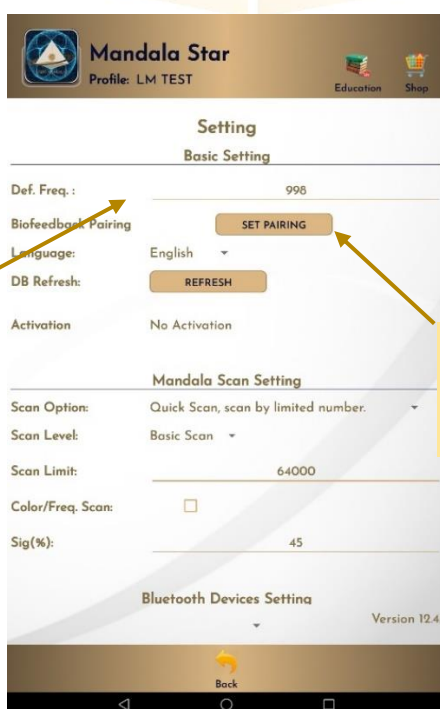

#### Default Frequency:

User can set the default frequency at here. The frequency for the Light Alchemy Pulsar Scan results will be in default frequency if the **Color/Freq. Scan** option in the settings is unticked.

#### Biofeedback Pairing:

Biofeedback function activate and deactivate.

### 5.3.5 Application Activation Status

The image shows two side-by-side screenshots of the Mandala Star app's 'Setting' screen, specifically the 'Basic Setting' section. The left screenshot shows the 'Activation' status as 'No Activation'. A yellow callout box points to this text with the text 'Application is not activated.' The right screenshot shows the 'Activation' status as 'Chatchaim Mr. Chatchai Pintalert Developer Release.'. A yellow callout box points to this text with the text 'Application is activated. The Activation details will show if the app is activated.' Another yellow callout box points to the 'Release.' text with the text 'Tap "Release" to release Activation Code.' A large yellow arrow points from the left screenshot to the right screenshot, indicating the transition.

Each activation code can only be used up to **maximum 5 different tablets**. If the activation code is already used to activate 5 different tablets, and user wish to use the activation code on 6<sup>th</sup> tablet (e.g. change tablet), user has to release the activation code from either one of the previous activated tablet first.

## 6 Mandala Astral Star

Tap on the **Mandala Astral Star** icon in the **Mandala Star Application Main Page** then you will go to **Mandala Astral Star Home Page**.



### 6.1 Library

To play the pattern directly from the library, tap on any of the libraries and choose the pattern you wish to play.





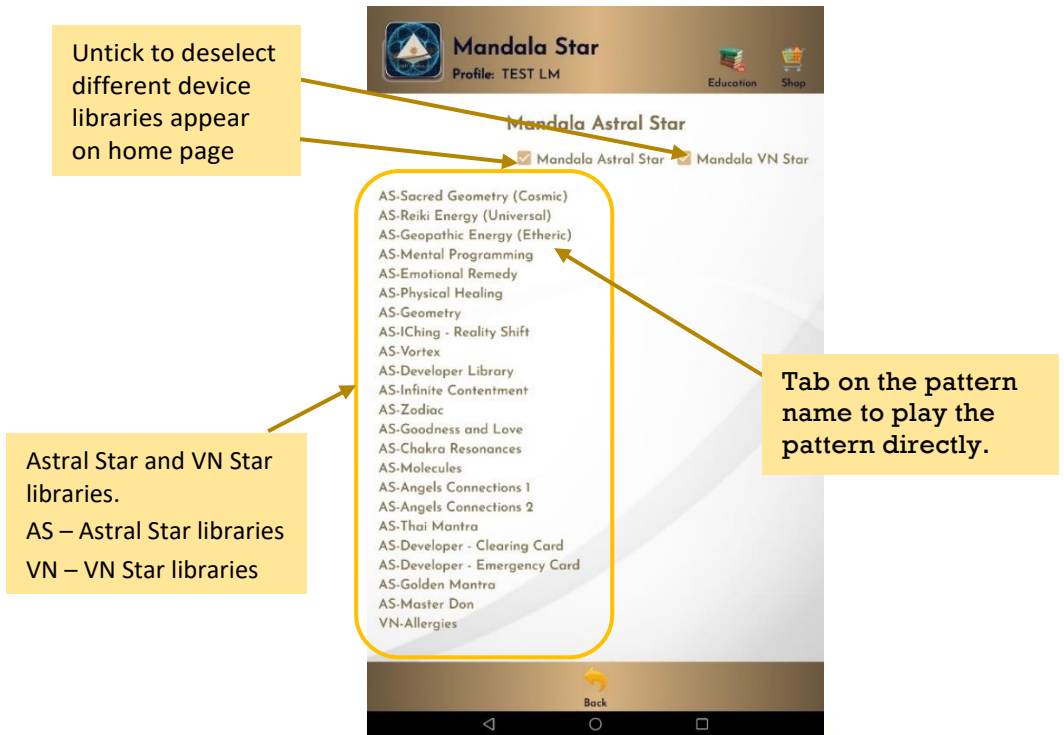

User can switch to different libraries from the **Select Library** drop list.

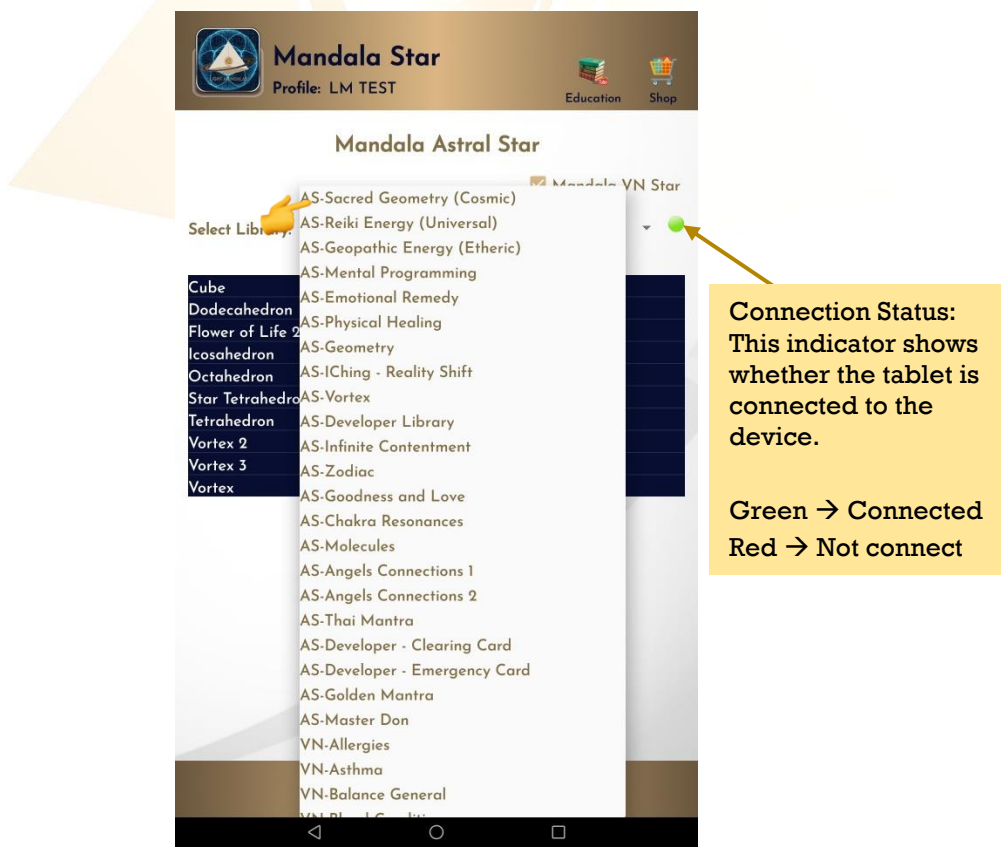

### 6.1.1 Pattern/item Laser Light Color Selection

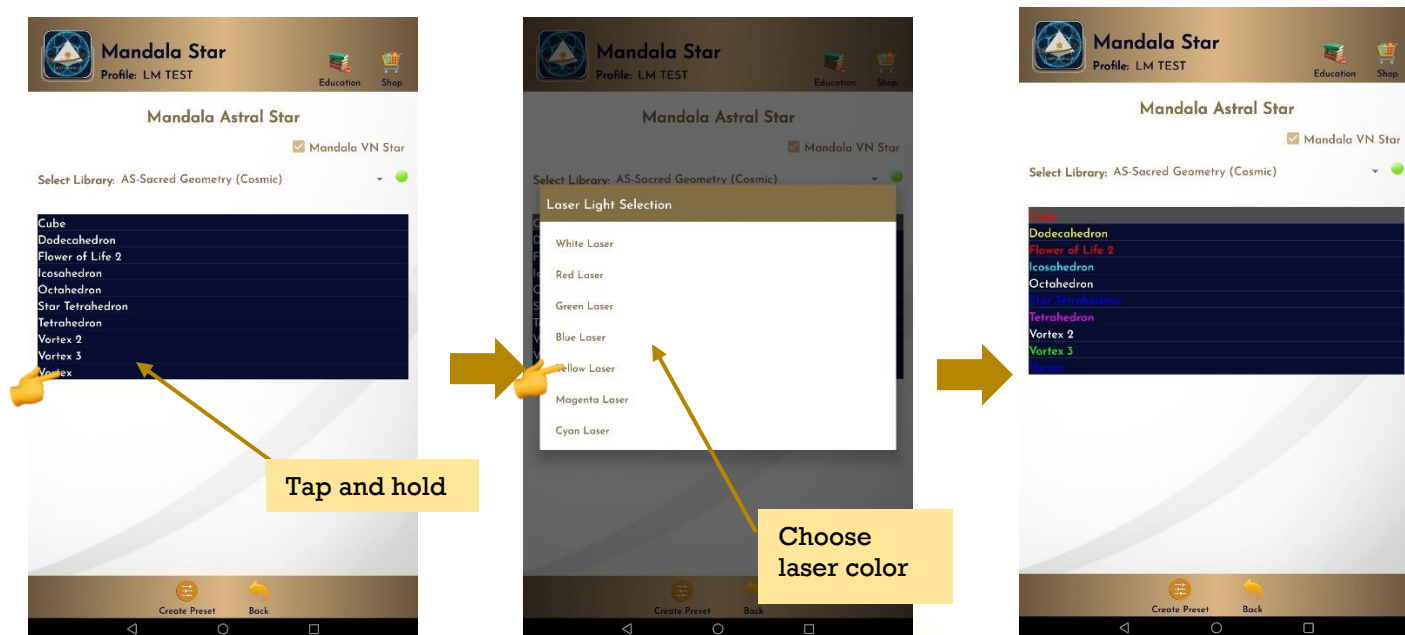

## 6.2 Pre Scan

This function will help user to choose the priority/significant libraries by user body coherence.

**\* Remember to pair Mandala Dynamic Scan with tablet prior to use this function.**

**Tap Scanner Preset to choose Pre Scan or Scan**

**The number of scans for this library during this scan.**

**\* The higher the number of scans of the item, the more significant the item is in this scan, and so on.**

**Grey color items represent insignificant libraries in this scan.**

**\* The significant % can be set by the user in the application settings.**

Item Name	Percentage	Significance
AS-Angels Connections 1	4.70%	Significant
AS-Molecules	4.70%	Significant
AS-Zodiac	4.66%	Significant
AS-Sacred Geometry (Cosmic)	4.63%	Significant
AS-Mental Programming	4.63%	Significant
AS-Developer - Emergency Card	4.62%	Significant
AS-Geometry	4.60%	Significant
AS-Thai Mantra	4.58%	Significant
AS-Master Don	4.56%	Significant
AS-Goodness and Love	4.54%	Significant
AS-Developer Library	4.54%	Insignificant
AS-Vortex	4.53%	Insignificant
AS-Developer - Clearing Card	4.53%	Insignificant
AS-Golden Mantra	4.52%	Insignificant
AS-IChing - Reality Shift	4.51%	Insignificant
AS-Angels Connections 2	4.51%	Insignificant
AS-Physical Healing	4.50%	Insignificant

### 6.3 Scan

User can tap on **Scan** icon on the **Pre Scan Results** to continue the further scan or directly tap on **Scan** icon on the **Mandala Astral Star Home Page** to manually select specific library to scan.

Tap on **Scan** icon on the **Mandala Astral Star Home Page** and manually select library to scan.

**OR**

**Scan Results**

**Select all library to scan**

**Select specific library to scan**

**Combine Scan:**  
Combine all selected libraries in one list to scan. The scan results will show in only one preset library. (Fast. For general.)

**Scan – Multiple Scan:**  
Scan all selected libraries one by one. The scan results will show in separate preset library. (Take longer time. More accurate.)

### 6.3.1 Combine Scan

Select all library or specific library to scan and tab on the **Combine Scan**.

**\* Remember to pair Mandala Dynamic Scan with tablet prior to use this function.**

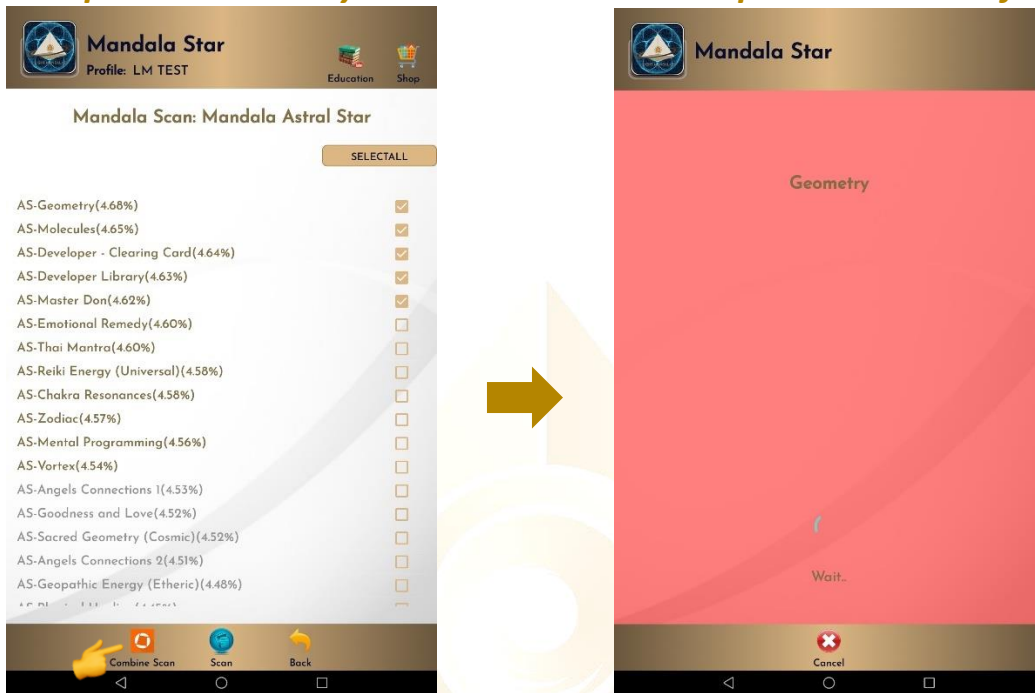

### Create Scanned Preset from Combine Scan Result:

If **Color/Freq. Scan** is **unticked** in app **Setting**, the scan will run in default mode which end up with all white color scan result items only.

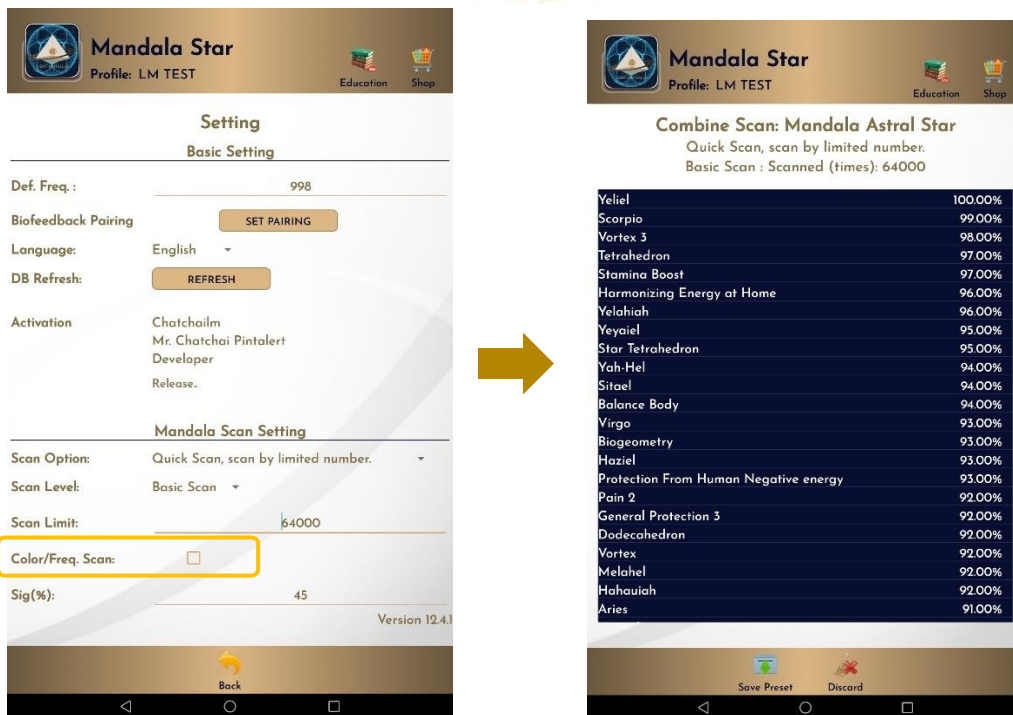

If **Color/Freq. Scan** is ticked in app **Setting**, the items of the scan results are in different laser color.

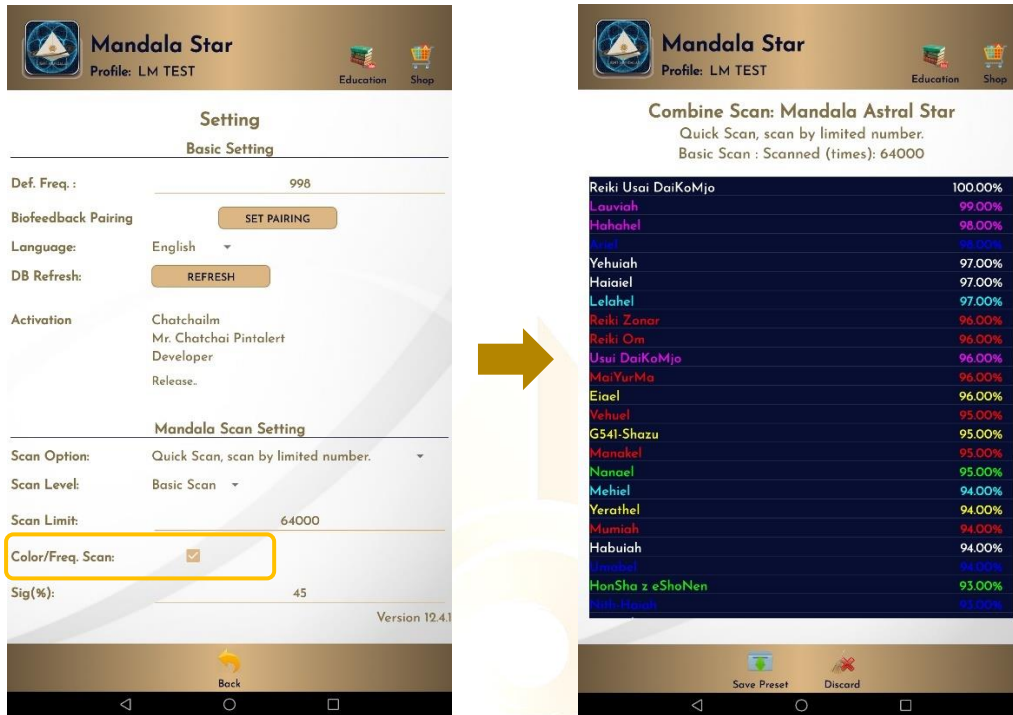

The scan results will show after the scan is completed. Then, tab on **Save Preset**. Select the item you wish to save and tab on **Save Preset** again to save it into the Scanned Preset.

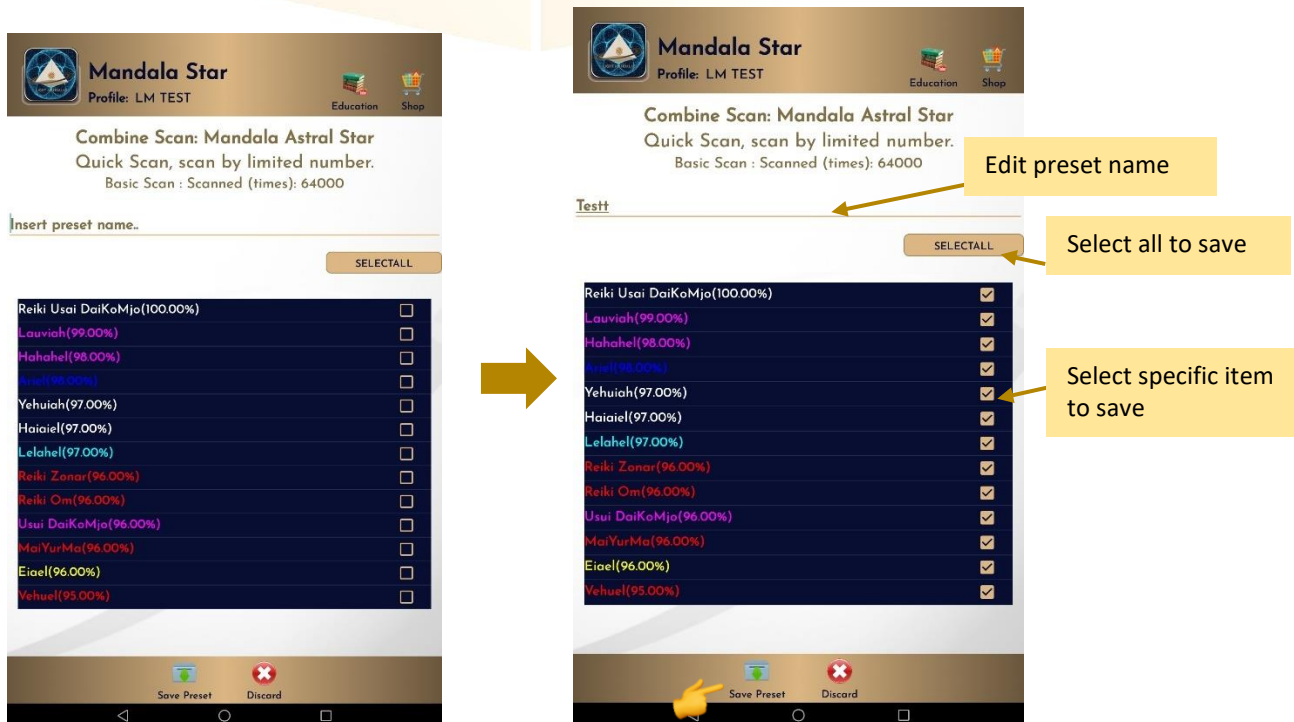

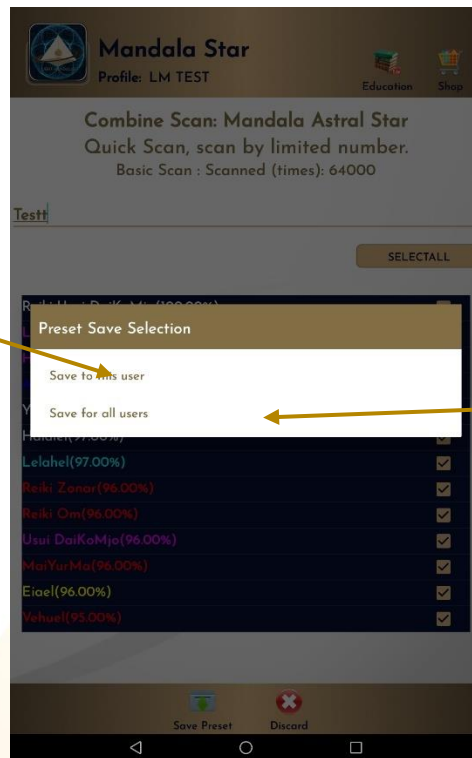

**Save to this user.**  
Only this user can see and play this scanned preset in the scanned preset library

**Save for all users.**  
Everyone can see and play this scanned preset in the scanned preset library

When the presets are saved, tab on **Discard** and select **Confirm** to go back to **Mandala Astral Star Home Page**.

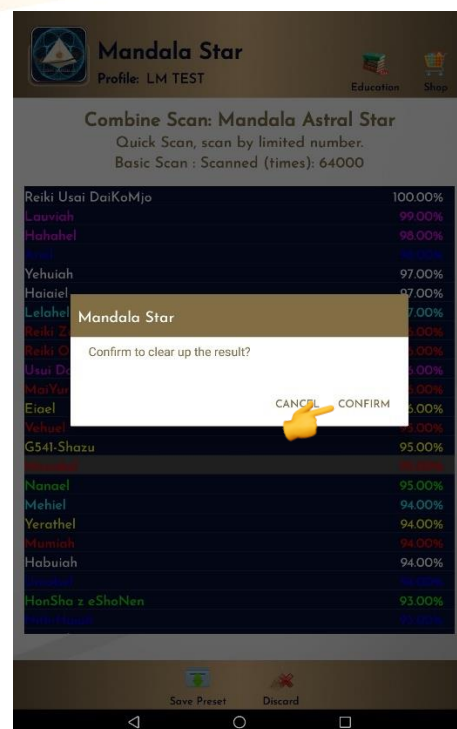

### 6.3.2 Multiple Scan

Select all library or specific library to scan and tab on the **Scan**.

**\* Remember to pair Mandala Dynamic Scan with tablet prior to use this function.**

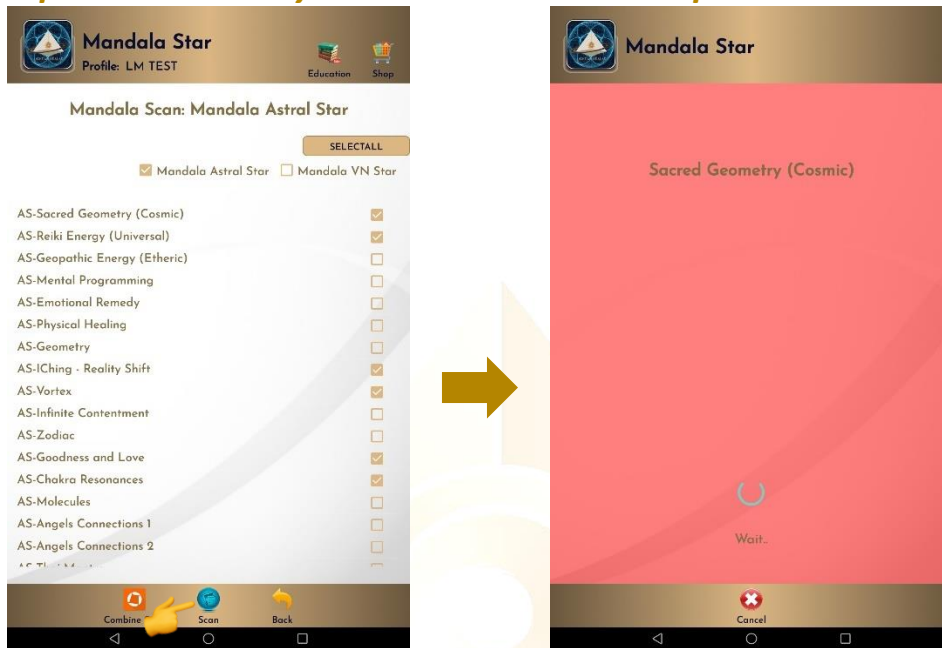

### Create Scanned Preset from Multiple Scan Result:

The scan results will show after the scan is completed.

#### 1. Choose specific preset in the library to save:

Tap on any libraries to choose the specific items to save

Select all to save

Select specific item to save

Grey color items represent insignificant libraries in this scan. The significant % can be set by the user in the application settings.



## 2. Choose specific libraries to save:

In this save method, all frequency/items in each library chose will be saved including insignificant items (grey color items).

**Select all to save**

**Select specific library to save**

**Save to this user.**  
Only this user can see and play this scanned preset in the scanned preset library

**Save for all users.**  
Everyone can see and play this scanned preset in the scanned preset library

When the presets are saved, tab on **Discard** and select **Confirm** to go back to **Mandala Astral Star Home Page**.

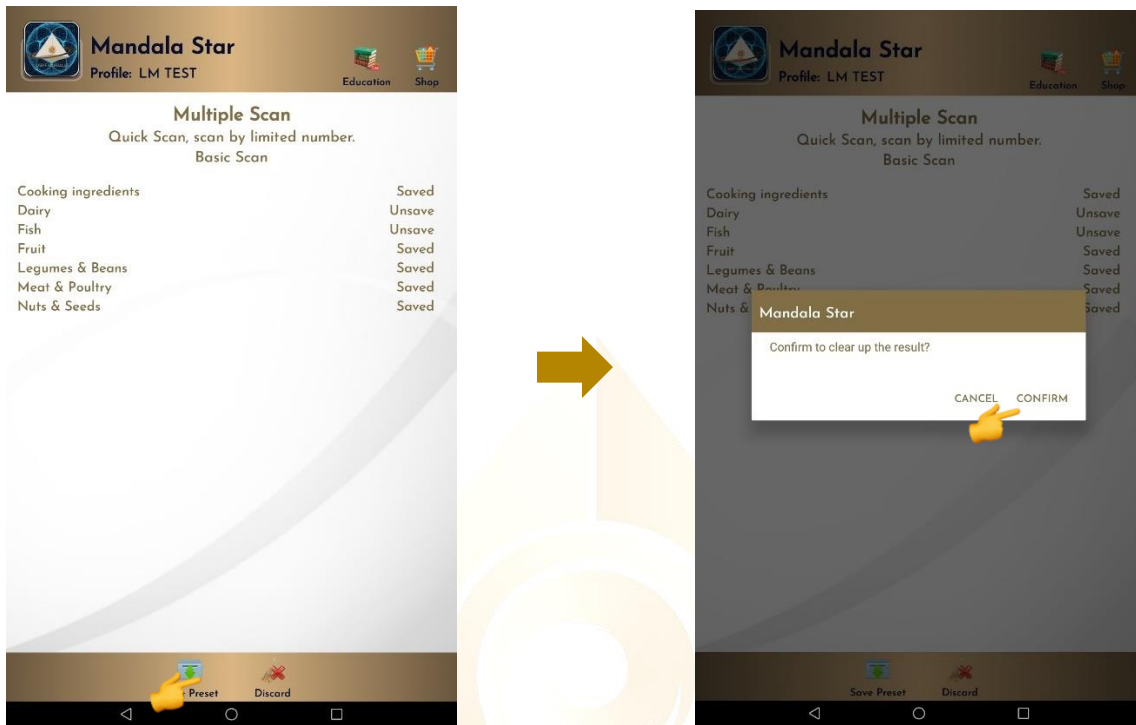

## 6.4 Preset

Tap on Preset and it will bring you to Preset Home Page.

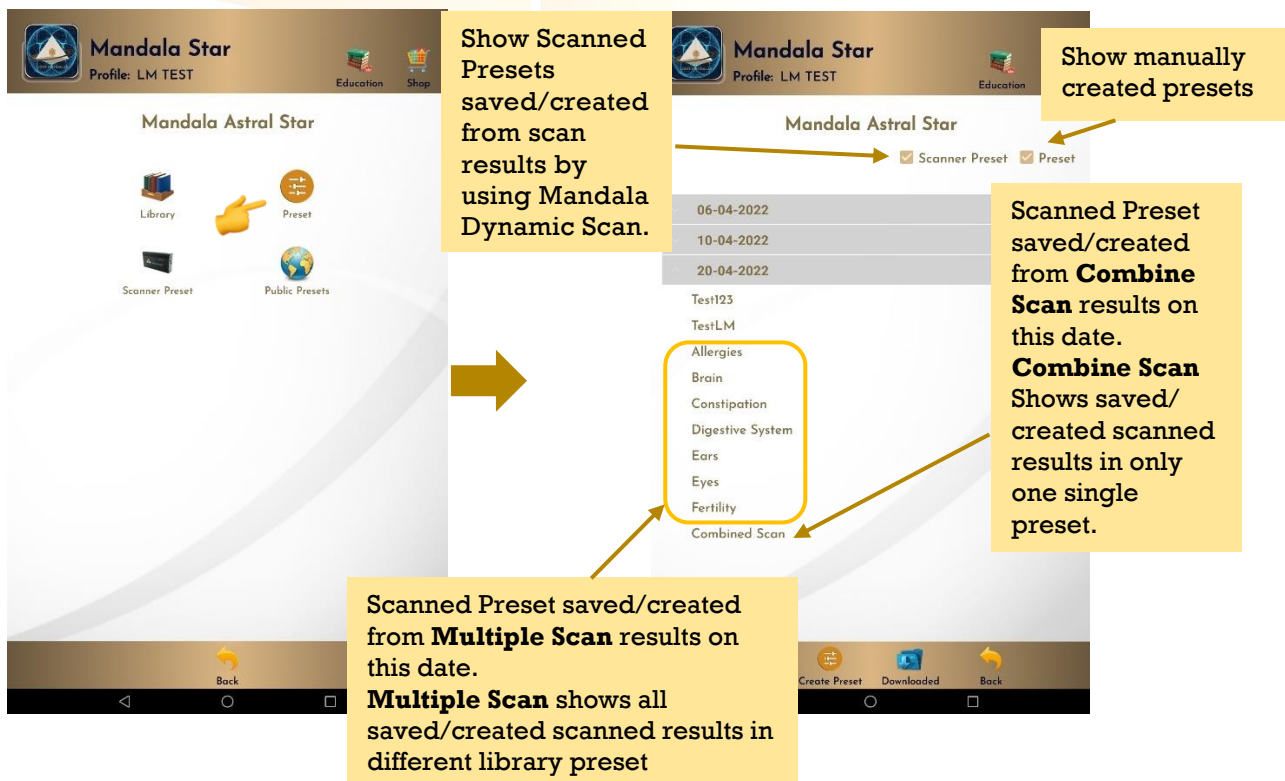

### 6.4.1 Basic Preset

User can choose to play **Basic Presets** created and shared by Light Mandalas team in this mode.

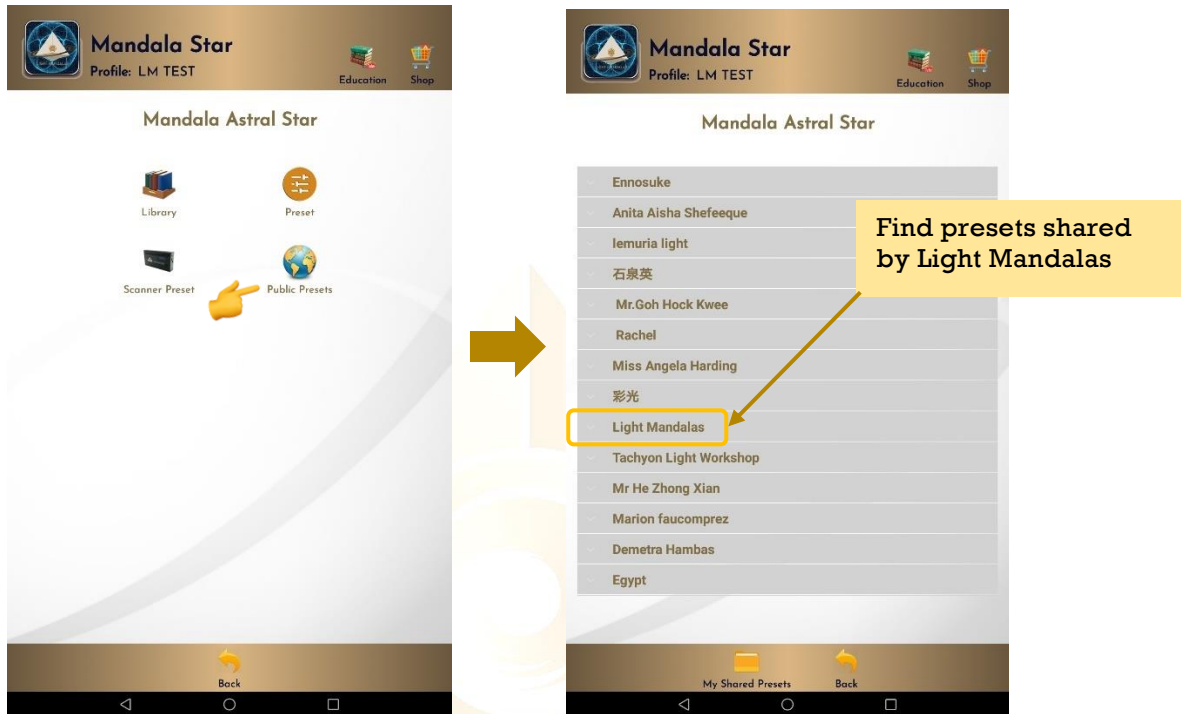

Tap on any library to show the selection.

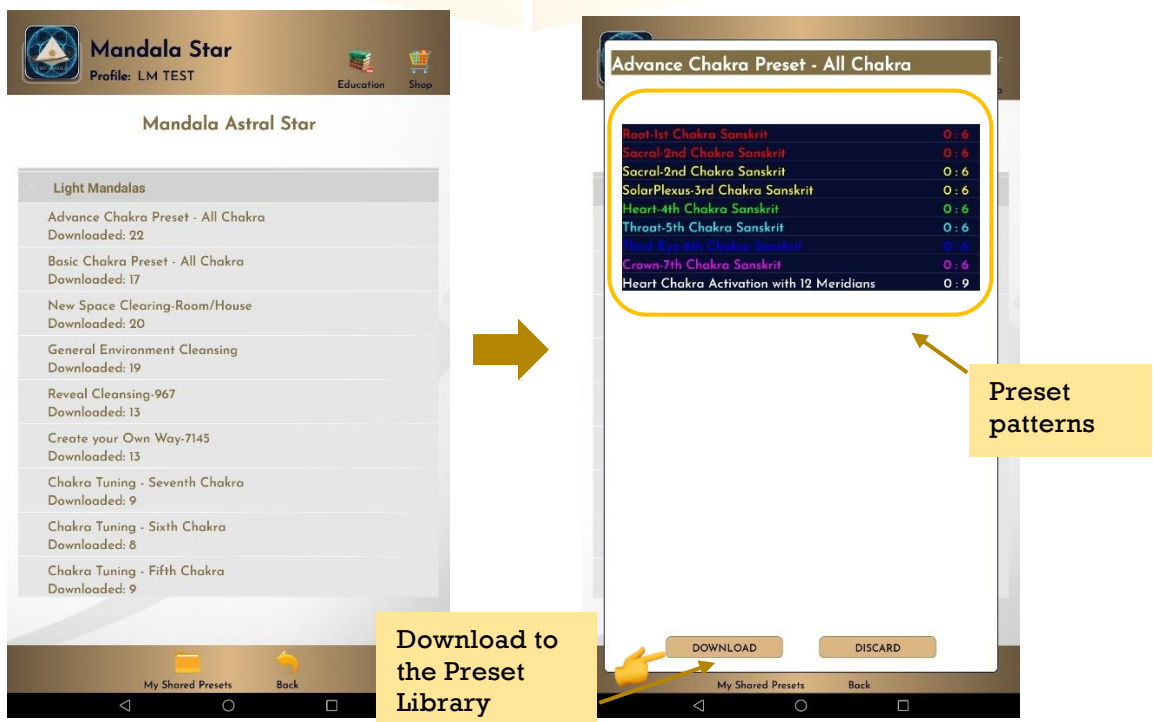

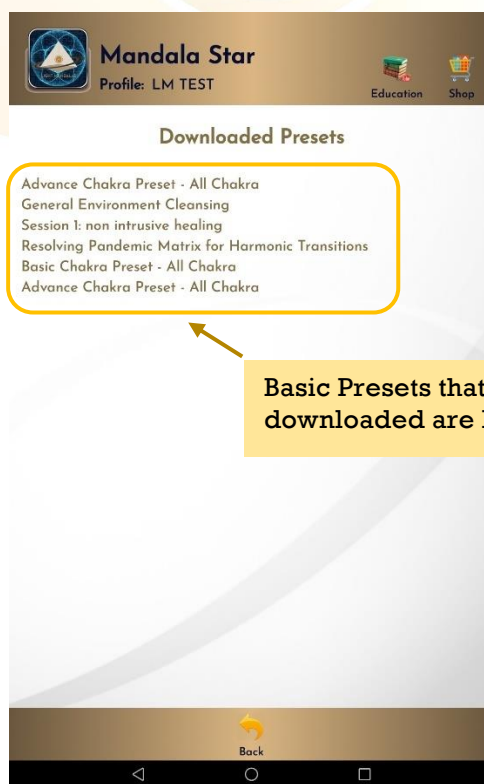
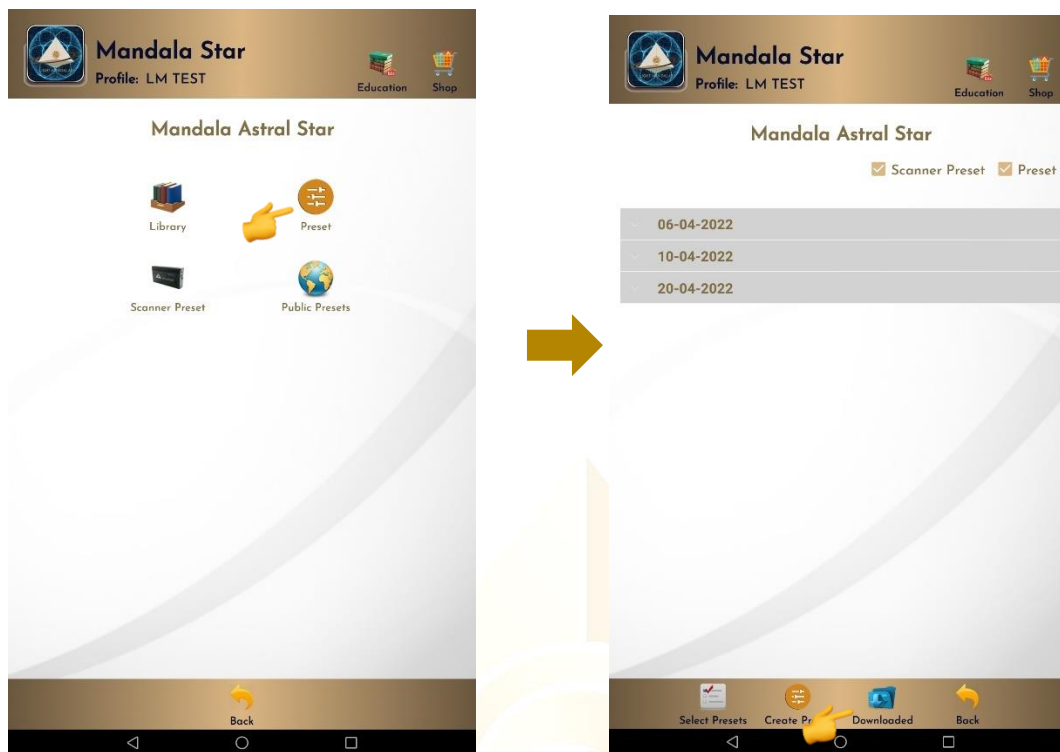

### 6.4.2 Create Preset

User can manually create/customize their own presets. When user is done with the preset pattern setup, tap on **Create** to save it.



### 1. Preset Pattern Laser Color Setup:

User can tap and hold any patterns to change the pattern’s laser colour.

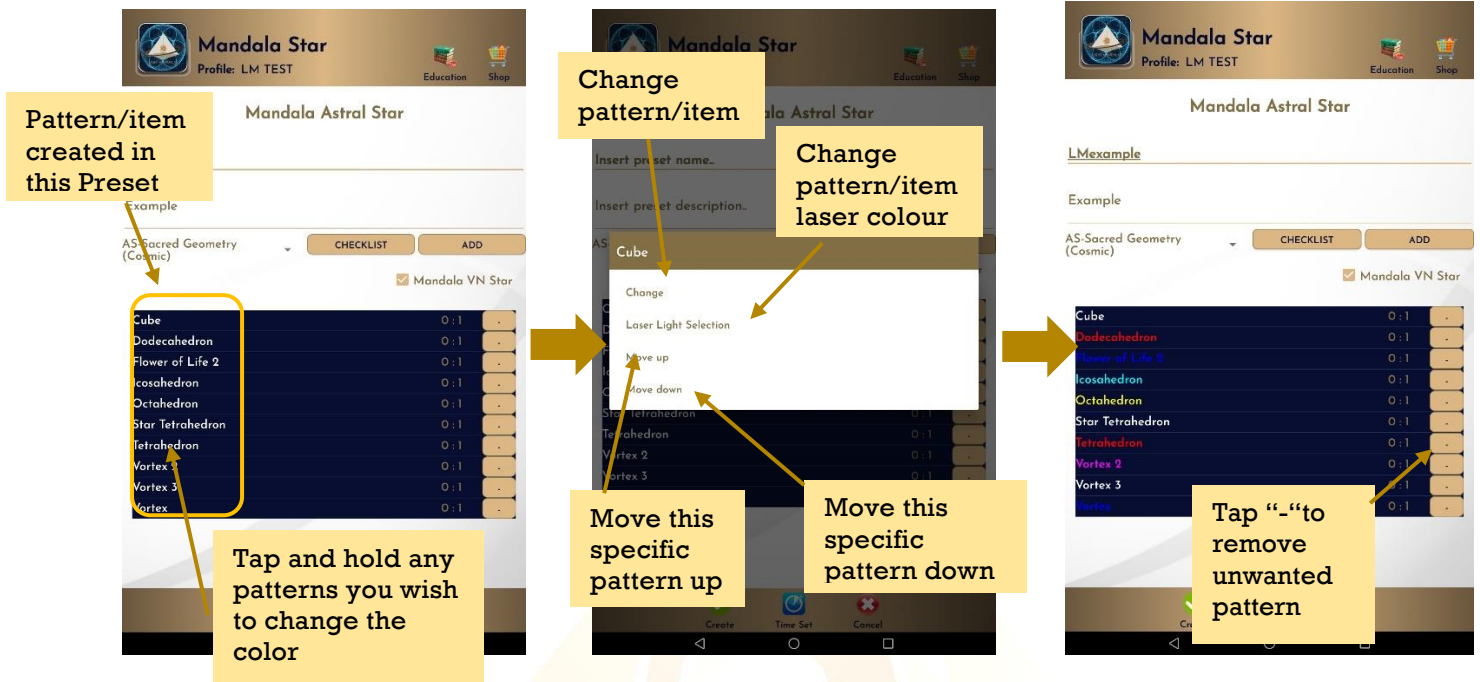

### 2. Preset Pattern Play Time Setup:

User can customize the play time for each pattern by tap on **Time Set** and choose the method of **Single Set** or **Set All**. When the time is set, user can tap on **Time Set** again to save it.

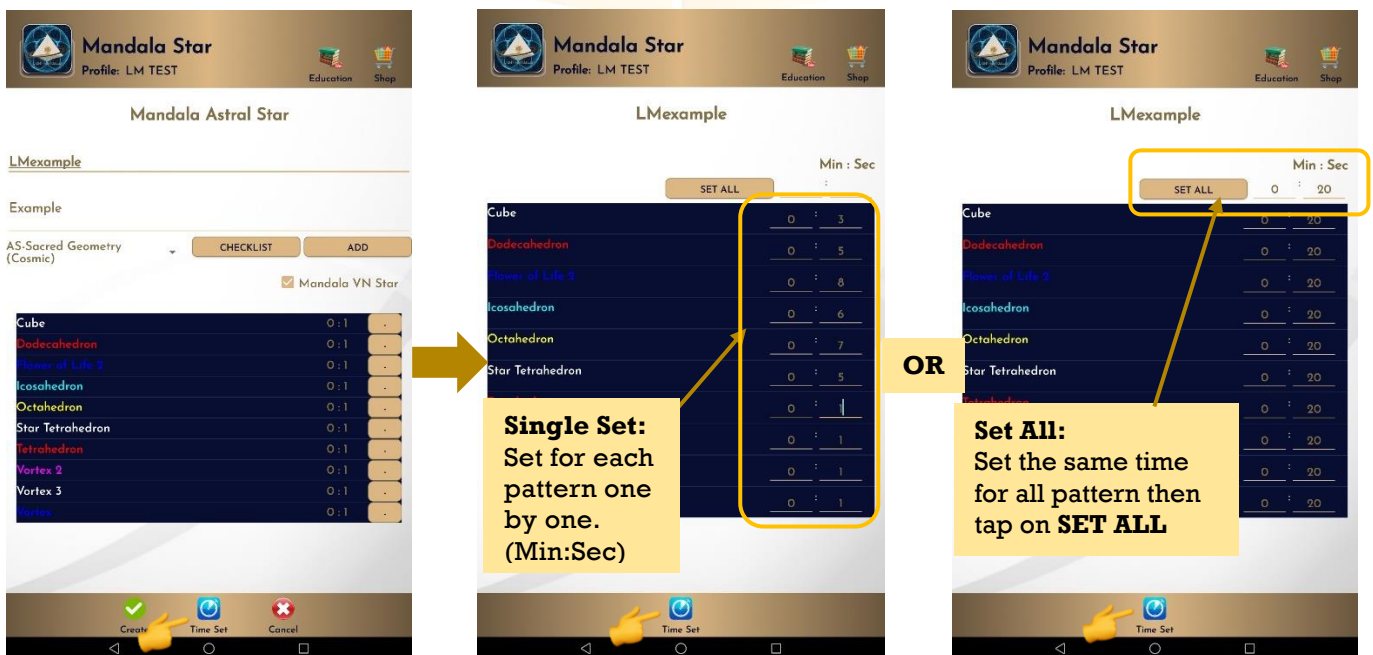

### 6.4.3 Preset Play Mode

#### 1. Select Single Preset:

Tap on any preset in the Preset Home Page you wish to play. Then, tap on **Enter** to enter to **Play Mode**.

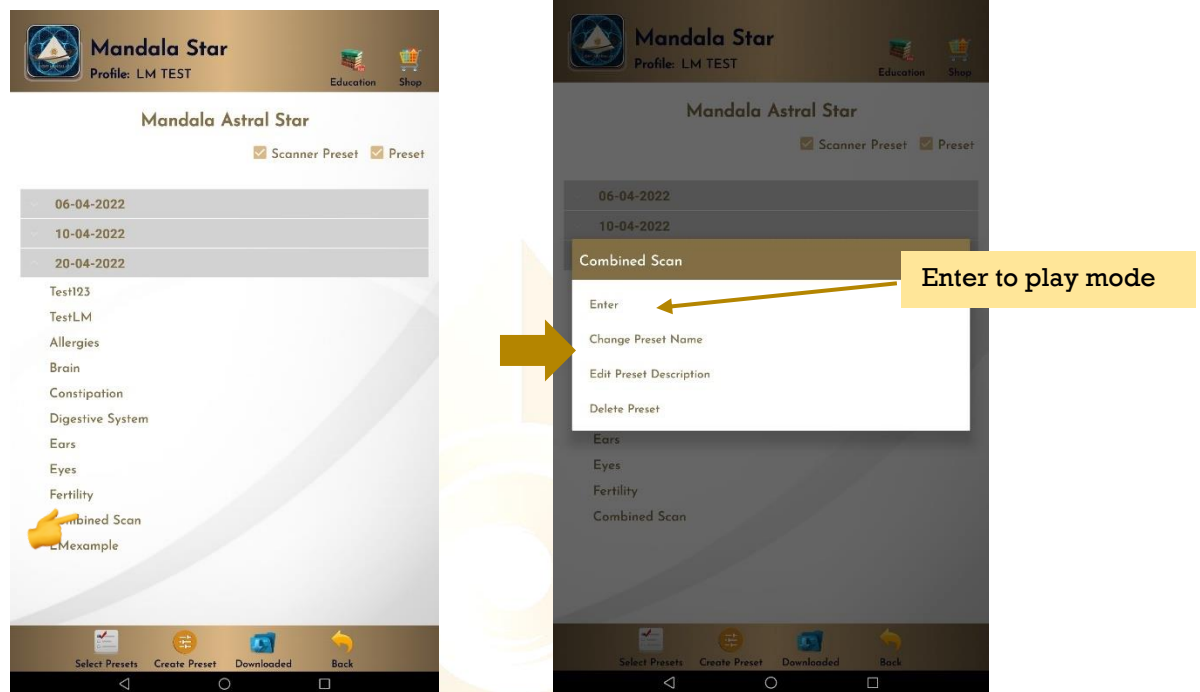

#### 2. Select Multiple Preset:

Tab on **Select Presets** to create a playlist to play together. User can select presets from **Scanned presets**, **Created Presets** or **Downloaded Basic Preset** and **Online Preset**.

**All Scanned Presets, manually Created Presets, downloaded Basic Presets and Online Presets will show in the same list**

**Tap Play to enter to play mode**

**Select presets to create playlist**

**Tap Delete Preset to remove unwanted preset.**

### 3. Play Mode:

Tap play to play the created playlist.

**Tick Repeat to repeat playlist/Looping**

**Tick Burst to set the numbers of repeat/loop. In this example the burst is set to 2. This means the playlist will repeat 2 times then stop.**

**Interval is the break time between each loop. In this example the interval for each loop is set to 3 seconds. This means the playlist will stop for 3 seconds before start to play the next loop.**

**Reset playlist**



User can tap **Back** to go back to previous page if wish to recreate the playlist.

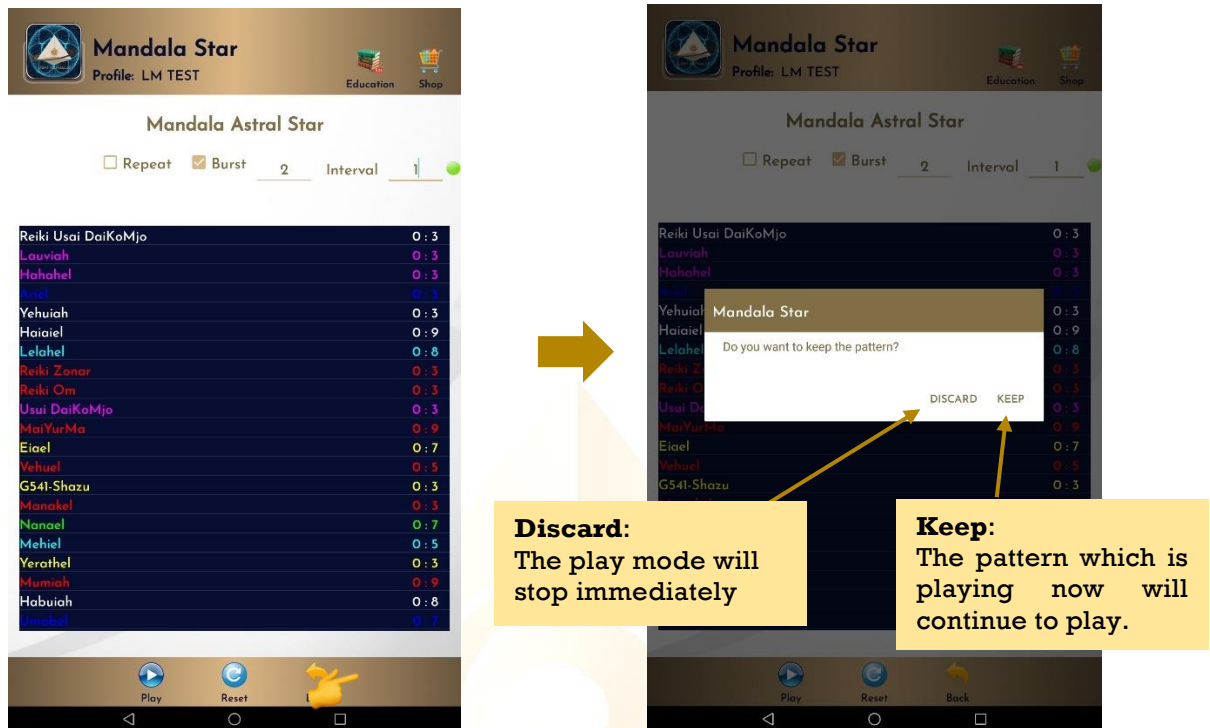

## 6.5 Online Presets

User can download presets shared by other users in **Online Presets** mode. User can also upload their preset online and share with other Light Mandalas user.

### 6.5.1 Download Preset

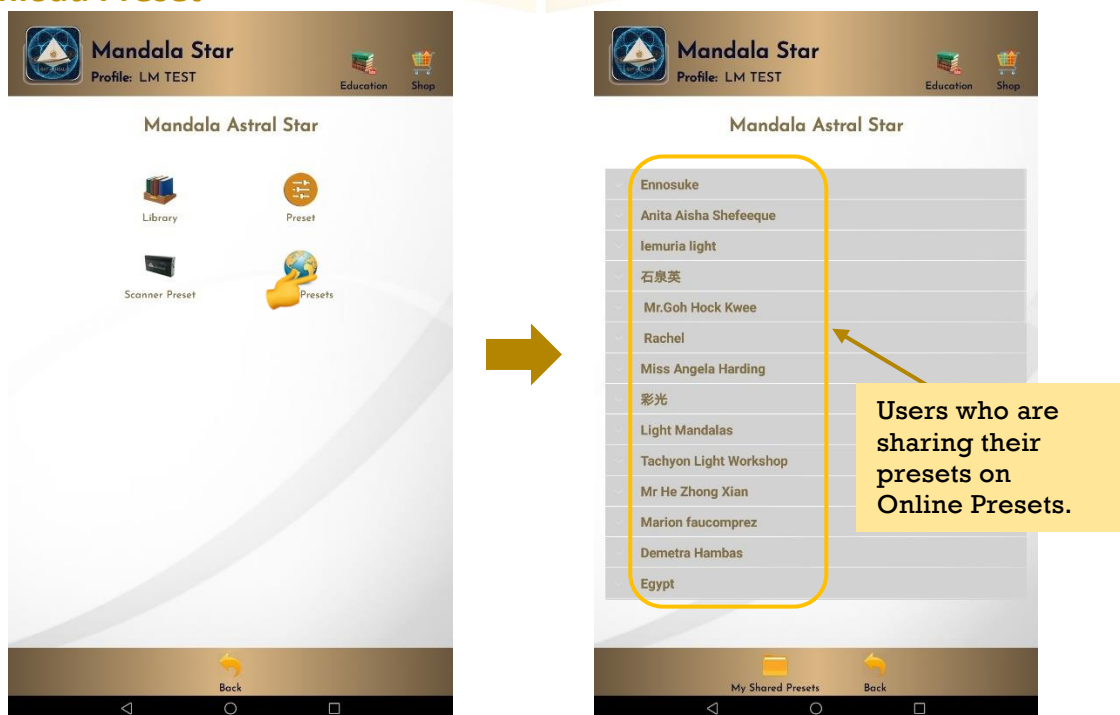

To download the online preset, tap on the user’s name to see what presets they are sharing. Then tap on the preset you want to download for more information and choose **Download**.

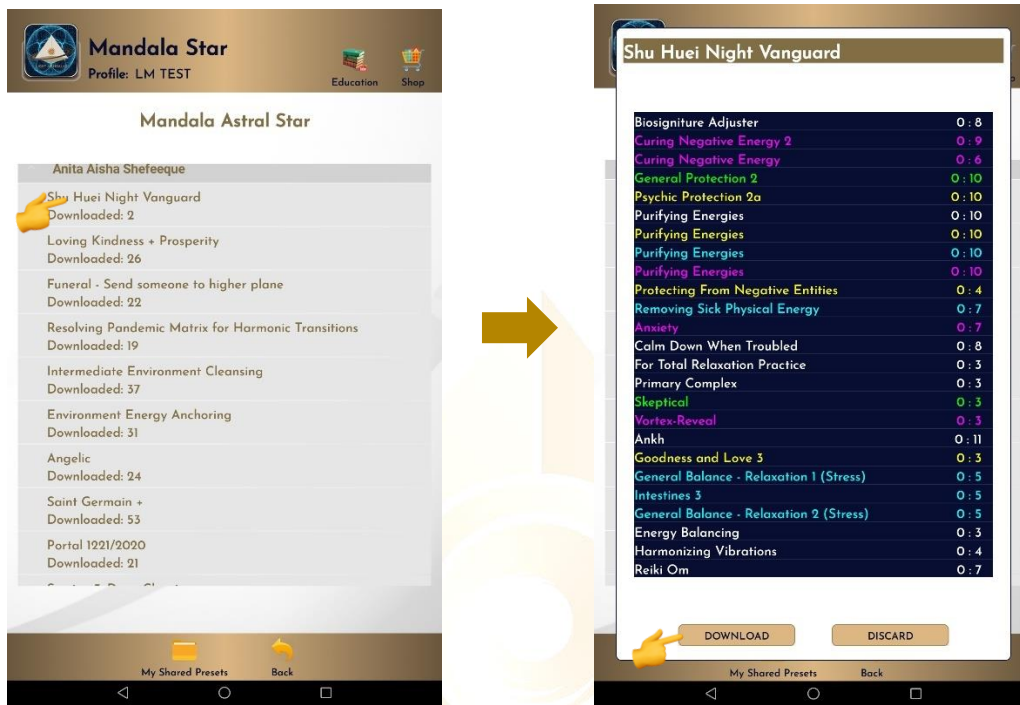

### 6.5.2 Upload Preset

For upload preset, tap on **My Shared Presets**, then tap on **Add** and choose the preset you wish to upload from the presets you have created earlier.

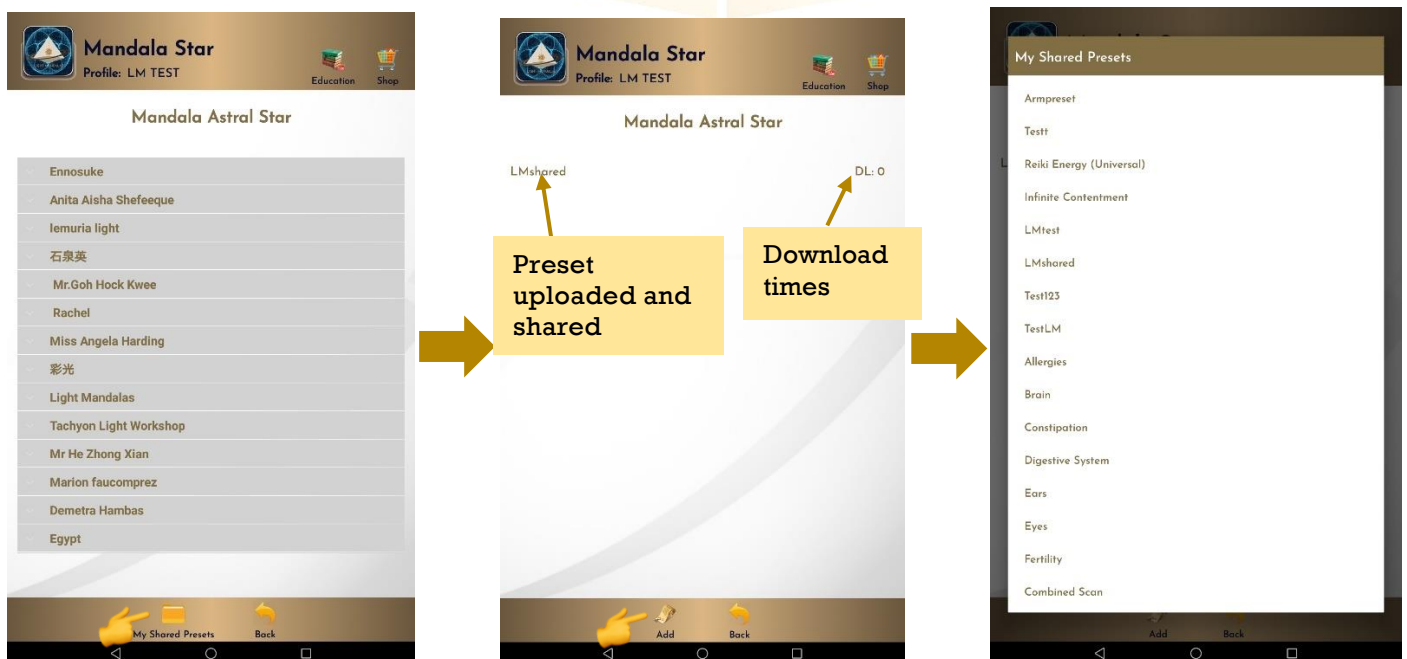

For delete the shared preset, tap on the preset and choose **Delete**.

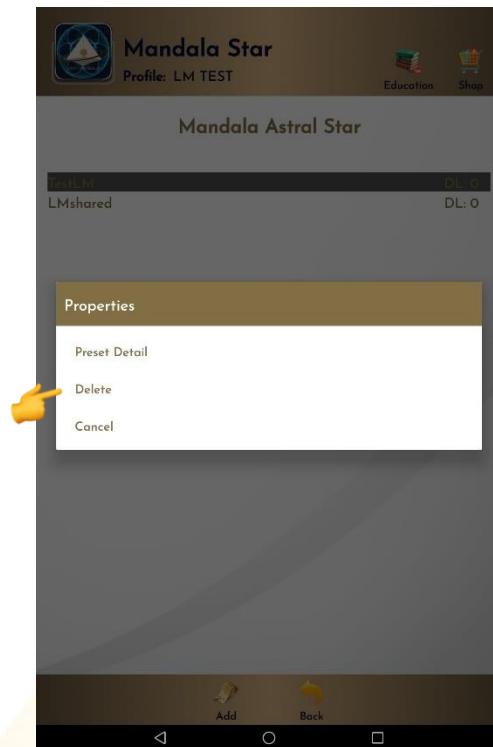

## Disclaimer

All content found on the Light-mandalas.com Website, Facebook Page, YouTube, including: text, images, video, audio, or other formats are intended for informational, educational and research purposes only and neither Light Mandalas Co. Ltd. nor the publishers of this content take responsibility for possible health consequences of any person or persons reading or following the information in this educational content and is not intended to be a substitute for professional medical advice, diagnosis, treatment or cure. Always seek the advice of your physician or other qualified health professionals with any questions you may have regarding a medical condition.

**“No claims other than stress detection and stress reduction may be made”**

Light Mandalas products are to be used as a Heart Rate Variability Biofeedback system and Light, Color and Sound therapy, designed for stress detection and stress reduction only. The devices do not evaluate any issue other than stress. Stress can come from many sources; this system uses light and color and sound therapies to reduce stress. Remember, there has never been any reported side effects using light, color, and sound therapy anywhere in the world and throughout time.

### **Notes on the practices of low-level laser therapy (LLLT) and Biofeedback**

Low-level laser therapy (LLLT) is considered investigational by the FDA, and no medical claims of cures are permitted in the US; at this time however, low-level lasers are defined within the scope of complimentary medical practices such as physiotherapy, aesthetic, Traditional Chinese Medicine, and acupuncture, etc.

The FDA does not regulate Bio resonance tools, but they do regulate biofeedback tools and some Bio resonance tools are registered under this category.

\*It is a legal requirement at this time that the user does not make any medical claims of diagnosis or cure.

### **Precaution**

Light Mandalas products are working on energetic level. The standard benefit is energy clearance. During the process, your body and mind can be uncomfortable. The symptoms associated with overly rapid clearance of toxins. If those detox symptoms are too strong, you may need to stop using the products. You have to allow the clearance or detox to proceed, and you can start to try the products afterwards. However, if the issues remain the same, it may need to be completely discontinued for your own safety

**Shall there be any inquiry, please contact us for further support.**

**Light Mandalas Co., Ltd. (Thailand Headquarters):**

- **Light Mandalas Website:** [www.light-mandalas.com](http://www.light-mandalas.com)
- **Official:** [info@light-mandalas.com](mailto:info@light-mandalas.com)
- **Instagram:** [@mandalawave9](https://www.instagram.com/mandalawave9)
- **YouTube Channel:** Light Mandalas Official
- **Technical Support Email:** [cservice@light-mandalas.com](mailto:cservice@light-mandalas.com)

**Local agents contacts:**

- **Japan:** [japan@light-mandalas.com](mailto:japan@light-mandalas.com)
- **Taiwan:** [lovelight777888@gmail.com](mailto:lovelight777888@gmail.com)
- **Indonesia:** [lightseed2020bali@gmail.com](mailto:lightseed2020bali@gmail.com)
- **West Malaysia:** [lightworker@healingtech.org](mailto:lightworker@healingtech.org)
- **East Malaysia:** [malaysia@light-mandalas.com](mailto:malaysia@light-mandalas.com)
- **Hungary:** [horesnyibela@light-mandalas.com](mailto:horesnyibela@light-mandalas.com)
- **Switzerland, Germany, Austria, and the Netherlands:** [info@light-mandalas.ch](mailto:info@light-mandalas.ch)
- **France, Spain:** [france-spain@light-mandalas.com](mailto:france-spain@light-mandalas.com)
- **USA:** [usa@light-mandalas.com](mailto:usa@light-mandalas.com)
- **New Zealand, Australia:** [tachyonhealing.nz@gmail.com](mailto:tachyonhealing.nz@gmail.com)